

Edge Clamp™

Installation Guide

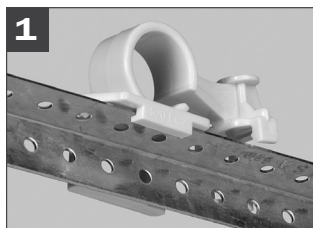

1 Position wide top lip over the back edge to hook onto bracket

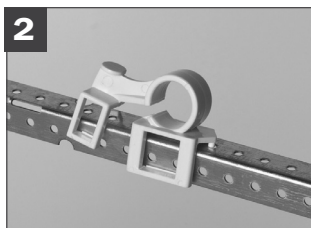

2 Then align tooth with hole in bracket. Install the clamp from the flat side (face) of the bracket.

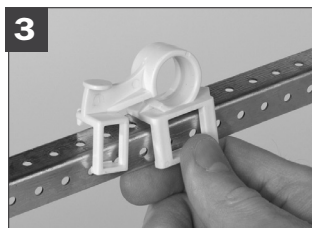

3 Use thumb and push wide lower lip onto bracket to engage the clamp.

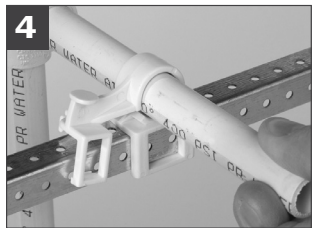

4 Install CTS pipe or stub out into pipe hole opening.

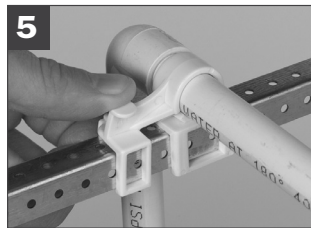

5 Push thumb tab down and slightly forward to engage both edges of the bracket.



6 Completed installation.

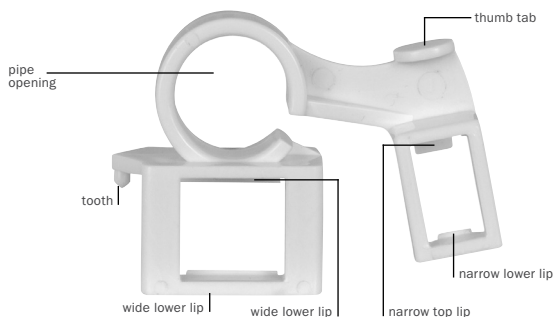

Supply

Drainage

Support

Specialties

www.siouxchief.com

TAKE THE FIELD.



Edge Bracket™

» Installation Guide

Face of Stud

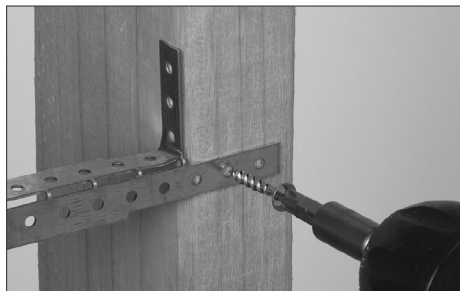

Use screws or nails to secure bracket to either the front or inside of stud.

Inside Stud

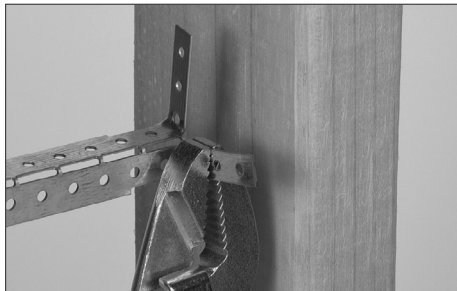

Bend in both tabs to fit the bracket inside the stud bay.

Self-Nailing Barbs

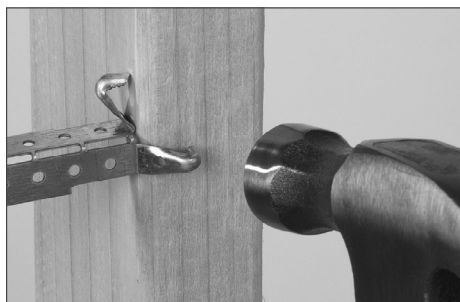

Edge brackets are also offered with self-nailing barbs that can be driven directly into wood studs.

Small Stud Bays

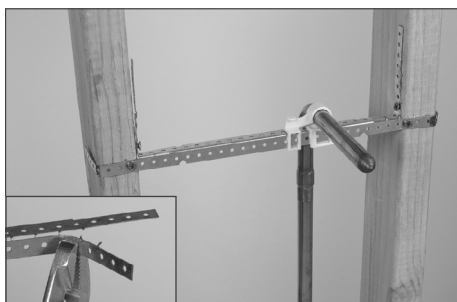

If stud bay is not wide enough, tear perforation on the vortex of the bracket to best fit the opening.

CAUTION: Brackets have sharp edges.
Wear gloves and use caution when installing the product.

- ⚠ **WARNING:** Cancer and Reproductive Harm
 - ⚠ **ADVERTENCIA:** Cáncer y Daños Reproductivos
 - ⚠ **ADVERTISSEMENT:** Cancer et effets néfastes sur la reproduction
- www.P65Warnings.ca.gov

#IS-520-E - 12/18

Supply

Drainage

Support

Specialties

www.siouxchief.com

14940 Thunderbird Road
Kansas City, MO 64147
P 1.800.821.3944
F 1.800.758.5950

