

# ASTM F2159 PEX POLYMER FITTING SYSTEM

## »» 6\_PX SERIES

Crimp™

### SPECIFICATION

Sioux Chief ASTM F2159 Crimp™ polymer PEX fitting system shall be used in hot and cold water distribution systems. Fittings are approved for use with ASTM F876 PEX tubing with copper crimp ring or stainless steel compression sleeve. Please contact Sioux Chief representative for specific product information within the Sioux Chief ASTM F2159 product offering.

### MATERIALS

Polyphenylsulfone (PPSU) - NSF Listed

### SAFE HANDLING

Solvents, glues, lubricants, pipe dopes, ethylene glycol, thread oils and paste should not come in contact with PPSU fittings. Store fittings away from petroleum products and direct sunlight (UV exposure).

### APPLICATIONS

Sioux Chief polymer F2159 fittings should only be used in operating conditions that are consistent with the temperature and pressure ratings of the tube and all applicable standards. F2159 fittings are suitable for radiant heating and cooling under the following conditions:

1. Use only propylene glycol (food grade) to maximum 60% by volume
2. DO NOT USE ETHYLENE GLYCOL WITH PPSU FITTINGS
3. Recommended Corrosion Inhibitors: Metal Guard™
  - H50 6% by volume
  - H60 4% by volume
  - H80 4% by volume

### INSTALLATION NOTES

Full installation instructions can be found at [www.siouxchief.com](http://www.siouxchief.com). Cut tube at 90-degrees. Do not crush OD of tubing with cutters. Be sure crimp/compression tool is properly calibrated. Compress with tool perpendicular to tube. Compress only once. Use a gauge to assure a proper joint. Remove defective connections. Pressure test all joints before use.

### DIMENSIONS per ASTM F2159

	1/2"	3/4"	1"
<b>A:</b> Ftg inside diameter	0.315" min	0.460" min	0.610" min
<b>B:</b> Ftg wall thickness	0.056" min	0.082" min	0.100" min
<b>C:</b> Ftg barb diameter	0.473" +/- 0.003	0.668" +/- 0.003	0.856" +/- 0.003
<b>D:</b> Fitting end length	0.70" +/- 0.020	0.70" +/- 0.020	0.85" +/- 0.020

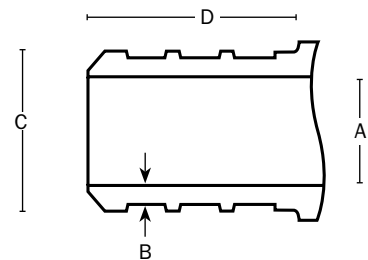

ITEM # SUBMITTED	_____
JOB NAME	_____
LOCATION	_____
ENGINEER	_____
CONTRACTOR	_____
PO#	_____ TAG _____



## Item Number Series

**632PX**\_ = MIP Elbow Adapters  
**637PX**\_ = FIP Swivel Adapters  
**640PX**\_ = Plugs  
**641PX**\_ = Tees

**642PX**\_ = Elbows  
**645PX**\_ = Couplings  
**646PX**\_ = MIP Adapters  
**672PX**\_ = Multi-port Tees