

F1807 ELBOW ADAPTER

» 637 SERIES

PowerPEX™

SPECIFICATION

Sioux Chief 637 Series elbow adapters for ASTM F1807 PEX shall be used where necessary in plumbing systems for distribution of hot or cold water. Adapters shall be made from copper tube and include brass FIP swivel nut with EPDM gasket for connection to MIP threads. Adapters shall be listed to appropriate standards including ASTM fitting end specifications.

MATERIALS

Elbow: Copper
Swivel Nut: Brass
Gasket: EPDM

DIMENSIONS

| | |
|---------------------------|-----------------|
| A: Width | 2.062" |
| B: Height | 2.227" |
| C: Nut connection | 3/4" FIP swivel |
| D: Barb connection | |
| 637X235 | 1/2" F1807 |
| 637X335 | 3/4" F1807 |

| | |
|------------------|-----------------|
| ITEM # SUBMITTED | _____ |
| JOB NAME | _____ |
| LOCATION | _____ |
| ENGINEER | _____ |
| CONTRACTOR | _____ |
| PO# | _____ TAG _____ |

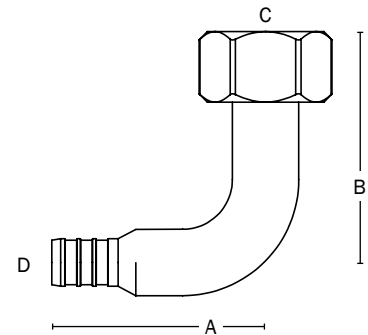

Create Item Number

637A

e.g. **637X235:** Copper/brass elbow adapter - 3/4" FIP swivel x 1/2" F1807 PEX

PEX CONNECTION SIZE A

X235 = 1/2" F1807 PEX connection

X335 = 3/4" F1807 PEX connection