

INSIDE PIPE DRAIN

» 845 SERIES

SPECIFICATION

Sioux Chief 845 series inside pipe drain shall be used where necessary in drainage systems. Drain shall have a nickel-bronze strainer and be designed to solvent weld inside most PVC/ABS Sch. 40 pipe. Strainer shall be suitable for finished areas and meet all load and flow requirements for intended use.

MATERIALS

Drain body: PVC with brass thread inserts

Strainer: Nickel-bronze

STRAINER LOAD RATING

1,000 lbs. (light duty)

STRAINER FREE AREA

3" Drain: 3.0 in²

4" Drain: 4.5 in²

INSTALLATION

Stub up with Sch. 40 PVC pipe. Finish floor around pipe. Using inside pipe cutter, cut pipe below¹ finished floor surface. Prime and solvent weld the drain inside of pipe using appropriate solvent cement, according to manufacturer's instruction. Push into pipe until strainer is flush with finish floor. Always follow local plumbing/building codes.

DIMENSIONS

	3" Drain	4" Drain
A: Strainer diameter	3.5"	4.5"
B: Overall height	1.5"	2.25"
C: Connection	Inside 3" Sch. 40 ²	Inside 4" Sch. 40 ²

¹ For pedestrian traffic, pipe can be cut 3/16" - 3/4" below finish floor surface. For heavier loads, the pipe should be cut such that it supports the outer rim of the nickel-bronze strainer

² The inside diameter of pipe can vary significantly - Drain fittings are designed to fit inside most, but may not fit all Sch. 40 pipe.

ITEM # SUBMITTED	_____
JOB NAME	_____
LOCATION	_____
ENGINEER	_____
CONTRACTOR	_____
PO#	_____ TAG _____



845-83PN

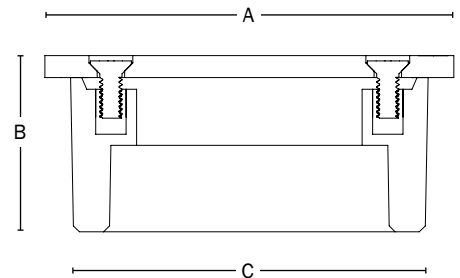

Create Item Number

845-A

e.g. **845-83PN:** Inside pipe drain for 3" Sch. 40 pipe with round nickel-bronze strainer

DRAIN SIZE A

83PN = Inside pipe drain for 3" Sch. 40

84PN = Inside pipe drain for 4" Sch. 40