

ADJUSTABLE CLEANOUT WITH DECK FLANGE

» 822 SERIES

Halo™

SPECIFICATION

Sioux Chief 822 series Halo adjustable cleanout shall be used where necessary in drainage systems. Cleanout shall have a stainless steel deck/mounting flange and coated ductile iron body with no-hub connection. Cleanout shall allow adjustment of 3/4" above deck flange. Scoriated cleanout cover shall meet applicable load requirements for intended use. Cleanout shall include a sealing plug with raised square head situated in base adapter to prevent escape of sewer gas. Designed in accordance with ASME A112.36.2M.

MATERIALS

Ring/cover: Nickel-bronze, 304 Stainless steel
Head adapter: ductile iron
Deck flange: 19-gauge 430 Stainless steel
Sealing plug: elastomer gasket with polypro drive screw
Base adapter: ductile iron

COVER LOAD RATING

Nickel-Bronze: 2,500 lbs. (medium duty)
Stainless Steel: 3,000 lbs. (medium duty)

DIMENSIONS

A: Connection size	3" No-hub
B: Ring/cover diameter	
Round Square	5-1/2" 5-7/8"
C: Flange diameter	9-1/2"
D: Base diameter	5-7/8"
E: Base height	4-3/8"
F: Adjustable finish height	
Round Square	0" - 3/4" 5/16" - 3/4"

ITEM # SUBMITTED	_____
JOB NAME	_____
LOCATION	_____
ENGINEER	_____
CONTRACTOR	_____
PO#	_____ TAG _____



822-C3DSR

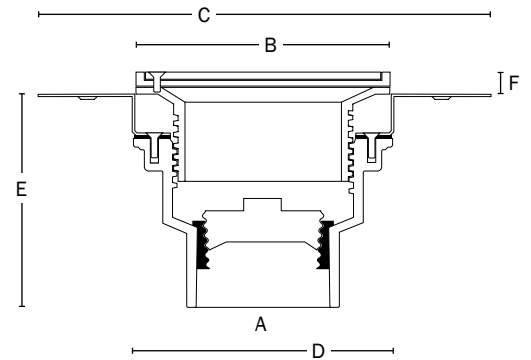

Create Item Number

822-AB

e.g. **822-C3DNRV:** Halo adjustable cleanout - 3" No-Hub connection and round, vandal-resistant nickel-bronze ring/cover

RING/COVER TYPE **A**

C3DNR = Round Nickel-bronze
C3DSR = Round Stainless steel
C3DNQ = Square Nickel-bronze
C3DSQ = Square Stainless steel

OPTIONS **B**

V = Vandal-resistant cover screws
S = Stamping (specify letters)
C = Carpet marker

Accessories - Available Separately:

822-EX3: Iron extension adapter - Fits between base and sleeve¹

¹ Extends head 1-3/4" (min) to 3-3/8" (max) above deck flange