

OVERHEAD BRACKETING SYSTEM

521-3725B

SPECIFICATION

Sioux Chief's galvanized stub out bracket shall be used where necessary to support 1/2", 3/4" or 1" nominal stub outs for water supply lines. Bracket shall be made from heavy-gauge, galvanized steel. Bracket design shall include holes to fit Sioux Chief PipeEye™ metal stud insulators or other types of plastic insulators that fit the pipe hole I.D. on the bracket. Bracket shall be IAPMO certified.

INSTALLATION

Using approved hardware (not provided), secure bracket with nail or screw to stud or base plate through any pre-drilled pilot hole. Insert stub out into pipe hole. Open plastic grommet to fit around pipe then push plastic grommet through the bracket. Molded ears on backside of grommet are designed to hold grommet in place.

MATERIALS

14-gauge galvanized steel

MAXIMUM LOAD RATINGS

25 lbs.

DIMENSIONS

| | |
|----------------------------------|--------------|
| A: Width | 2" |
| B: Height | 3" |
| C: Foot length | 1 3/4" |
| D: Number of pipe holes | 2 |
| E: Distance between pipe holes | 2" on-center |
| F: Outside diameter of pipe hole | 1 11/32" |
| G: Nail hole diameter | .187" |

| | |
|------------------|-----------------|
| ITEM # SUBMITTED | _____ |
| JOB NAME | _____ |
| LOCATION | _____ |
| ENGINEER | _____ |
| CONTRACTOR | _____ |
| PO# | _____ TAG _____ |



521-3725B

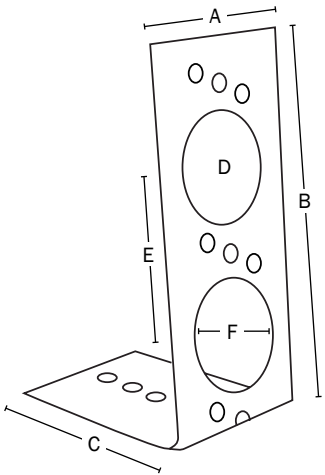

Made in USA

Create Item Number

521-3725B